

Thank you for purchasing a WallBox!

The WallBox series are perfect solutions for any application where low profile, all-in-one weatherproof powered mixers are needed.

The core of the WallBox is the audio mixer. The mixer offers four separate audio inputs, each with level control. The mixer includes a three-way ducking switch option as well as internally accessible crossover points and a basic limiter circuit.

The WallBox XL has an expansion bay where factory-installed source options such as a wireless microphone receiver, audio player and more can be mounted. Please contact Technomad to discuss application requirements if the unit was not ordered with the needed optional module. The unit also includes an accessory shelf where either an audio input or output accessory module can be mounted. There is a 3.5mm input cable located here so a portable device such as phone or tablet can easily and quickly be connected to the system.



Features

- Four individual input channels
 - 1x microphone/balanced line level
 - 3x unbalanced line level
- Three way ducking circuit
 - Wired mic ducking, line level ducking, off
- Integrated limiter
- Integrated crossover filters (factory set)
 - Full range, 85Hz high pass, 85Hz low pass, 350Hz high pass
- Weatherproof polycarbonate enclosure
- Stainless steel lockable hasp closure
- Three amplifier options:
 - 2x 50W, 1x100W, 1x150W mono (8Ω)

Connections

- Audio Input Jacks
 - 1x XLR- 1/4" TRS combo jack (front)
 - XLR pins = mic. level
 - 1/4" TRS pins = balanced line level
 - 1x 1/4" jack, unbalanced line level (front)
 - 1x expansion bay with internal connection header (TE Connectivity PN 1375820-3)
 - 1x 3.5mm input cable, unbalanced line level, (shelf)
 - 2x NL4MP speaker jacks

Power (standard)

- 120VAC
- 12VDC aux. power (USB)

Installation

The BreakoutBox series are designed to be installed onto a vertical surface. Each unit includes a set of mounting tabs which attach to the rear of the enclosure with included 10-32 flathead screws. These allow the unit to easily mounted using appropriate hardware. Alternately, the enclosure can be mounted using the four 10-32 inserts on the back of the unit to which the mounting tabs are bolted.

Connecting Audio Sources

To connect an external device to the unit, use an appropriate adaptor cable for the input. While the WallBoxes are mono devices, an audio source with stereo output can be connected using the included 3.5mm to 1/4 adaptor on line input 1. If the unit is purchased with the optional Bluetooth™ receiver module, that module will be wired in parallel to the unbalanced input so if both the Bluetooth receiver and a source plugged into that jack are used at the same time, there will be no individual level control for the two sources.

Technomad User Manual - WallBox

To connect a source module to WallBox in the Expansion Bay after purchase, use the Input 4 header on the mixer PCB (circled in red on the schematic). Access to these headers is gained by removing the front panel of the WallBox and should only be done by an experienced technician.

Output Connections

The standard WallBox configuration includes two Neutrik Speak-on NL4MP connectors. These are wired in parallel. Connecting more than two 8Ω speakers to the unit is not recommended due to impedance concerns. The amplifier output is wired to pair 1+/1- on the NL4MP jacks.

Operation

The WallBox provides four separate audio level controls, one for each channel. When setting levels for an audio channel be sure to monitor the 'Clip' LED to ensure that the mixer inputs are not being overdriven. Overdriving, or clipping, the input to the unit can lead to damage of the speakers connected to the system and should be avoided. Be sure all input level controls are turned fully down (max. counter-clockwise) before powering the unit on or off.

Ducking Switch

The unit includes a three way switch which controls the ducking feature. When the switch is set to the 'Mic' setting, any input from the wired microphone connection will override (or duck) any active input on other channels. When the switch is to the 'W. Mic' setting, any input from Expansion Bay will override any active input on other channels.

Available Source Options

Bluetooth receiver: PN 1775

Shure™ PGX D handheld wireless mic system w/ mounting brackets: PN 1717

Shure™ PGX D headset wireless mic system w/ mounting brackets: PN 2117

Samson Airline88 waterproof header mic system: PN 2096

Available Output Options

Source Splitter: PN 1714 (for use with more than two external PowerChitons. Installs either on the shelf or Expansion Bay.

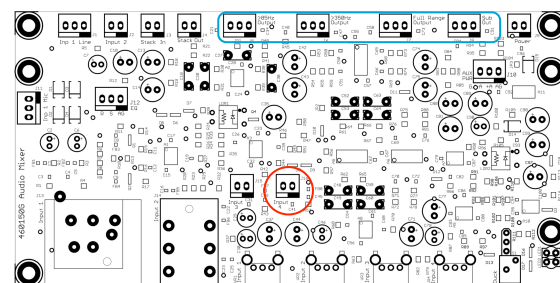
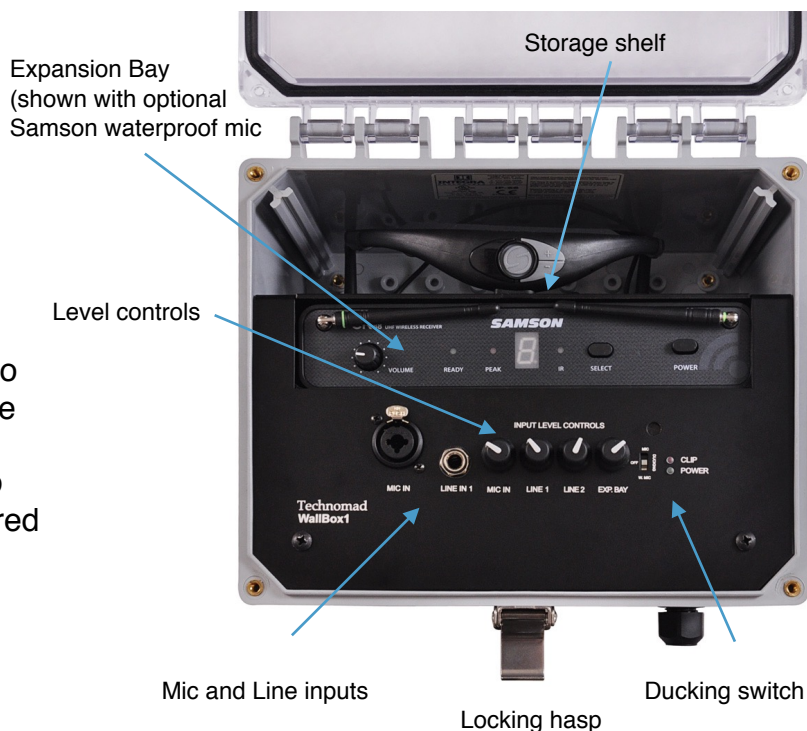

Mixer schematic